



OAKFIELD



Seaside, Eastbourne, BN22 7QR

£825 Per Calendar Month





## Seaside, Eastbourne, BN22 7QR

Just moments from Eastbourne's beautiful seafront, this bright one-bedroom flat offers the perfect blend of coastal living and convenience.

Comprising of an sectioned open plan living and kitchen space, double bedroom with access to the rear and a fully fitted bathroom with bath and shower - further benefitting from a private entrance, on street parking and situated on a row of local amenities.

The property is located conveniently with public transport links on your door step and a short walk into the town centre and train station

Please note:

An annual household income of £24,750 per anum is required.







**Living Room**  
14'9" x 12'1" (4.50m x 3.70m)

**Entrance Hall**  
31'2" x 8'2" (9.50m x 2.50m)

**Kitchen**  
11'5" x 6'2" (3.50m x 1.90m )

**Bedroom**  
15'5" x 12'9" (4.70m x 3.90m)

**Bathroom**  
7'2" x 6'2" (2.20m x 1.90m)

**Council Tax Band A - £1,266.24 Per Annum**



Floor Plan

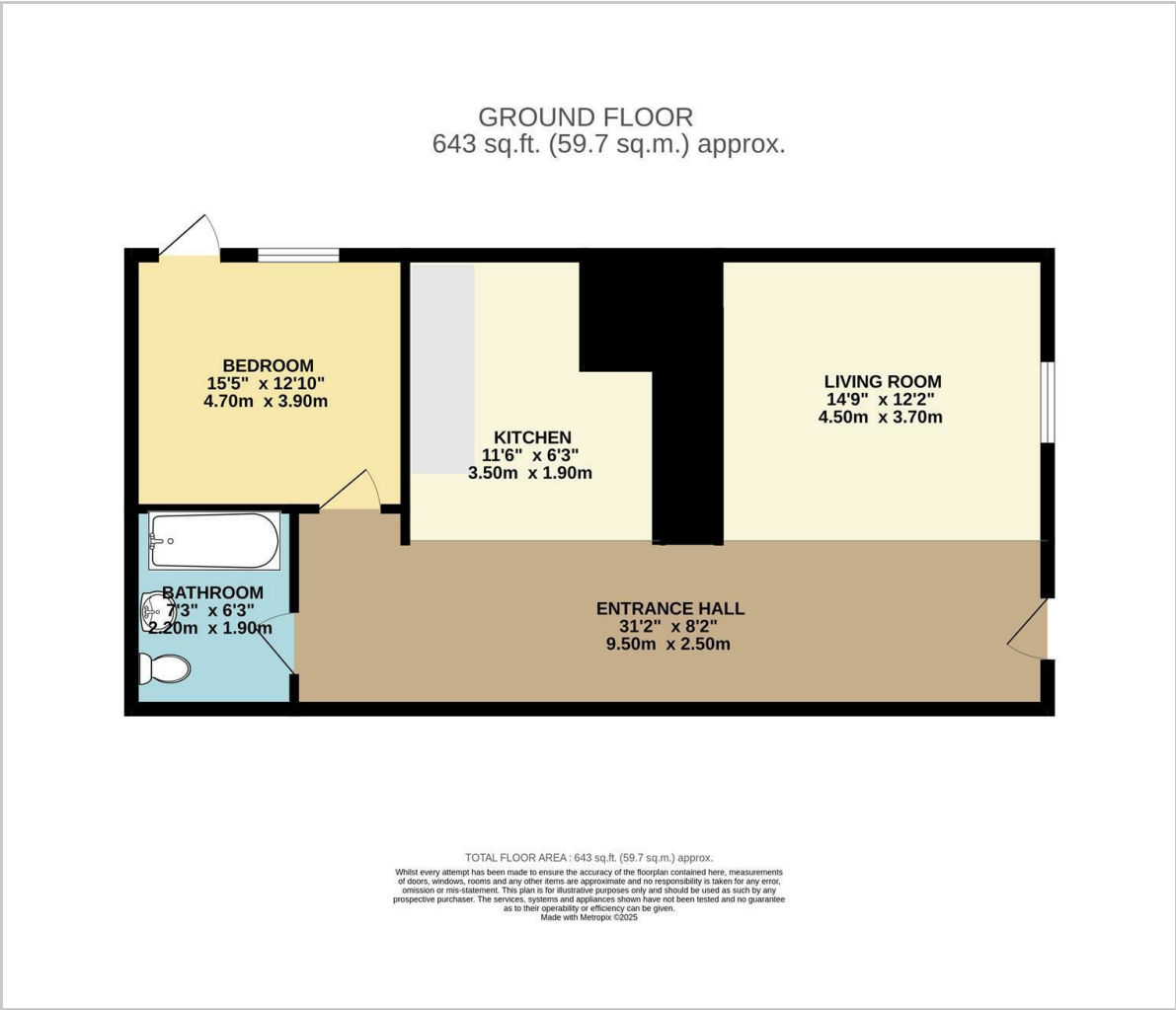

Viewing

Please contact us on 01323 405553  
if you wish to arrange a viewing appointment for this property or require further information.

These particulars, whilst believed to be accurate are set out as a general outline only for guidance and do not constitute any part of an offer or contract. Intending purchasers should not rely on them as statements of representation of fact, but must satisfy themselves by inspection or otherwise as to their accuracy. No person in this firms employment has the authority to make or give any representation or warranty in respect of the property.

Area Map

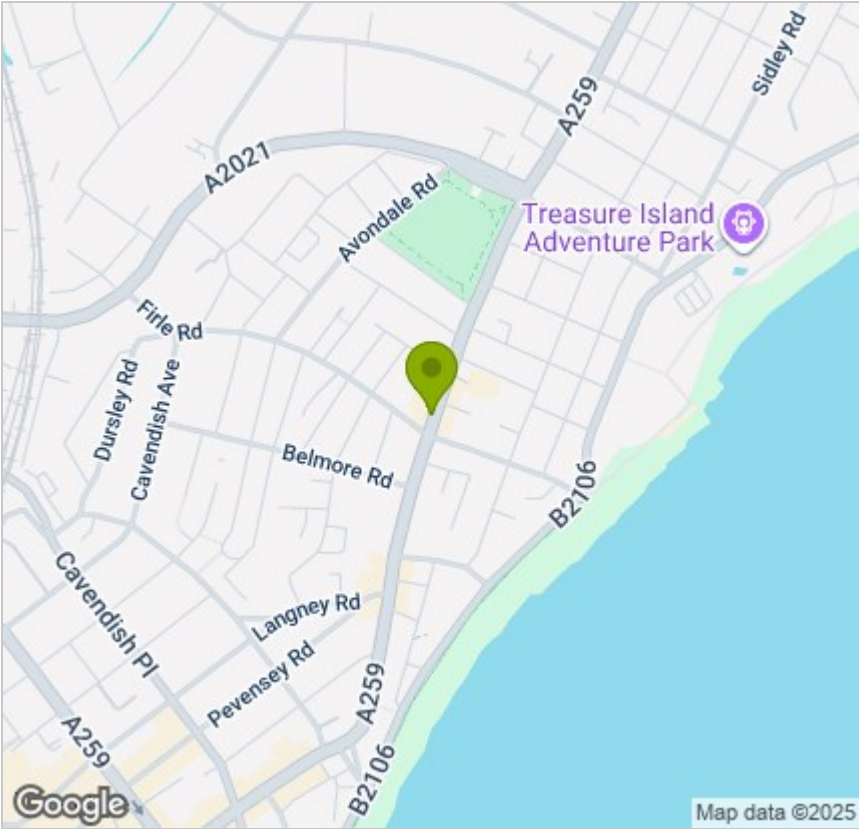

Energy Efficiency Graph

